



*Spring*

# HOME

## IMPROVEMENT 2

- Why excavation is best left to the professionals

- Turn your bedroom into a relaxing retreat



- How to build a fish pond the right way



**0% FINANCING AVAILABLE**  
PLUS INSTANT REBATES ON SELECT STIHL ZERO-TURNS

**FINANCING AVAILABLE ON YOUR ENTIRE PURCHASE**



+



**NORWICH OUTDOOR POWER EQUIPMENT**

5876 County Rd. 32- East River Road, Norwich  
607-334-4378 • [www.norwichope.com](http://www.norwichope.com)

Hours:  
8:00-5:00 Monday-Friday  
and  
8:00-12:00 on Saturday

# HOW TO BUILD A FISH POND THE RIGHT WAY

A water feature in the backyard is not only an attractive way to add dimension and visual interest to the entertaining space, it can also be a tranquil, relaxing place to which to retire. A pond filled with marine plants or fish can be a welcome respite in the yard.

For those who haven't done major excavation or built something similar in the yard before, it pays to become educated before digging the first hole. In order to ensure the fish pond goes in correctly, there are a few things the do-it-yourselfer needs to know.

- Determine size. Many first-time pond builders simply make their ponds too small. If fish or a lot of aquatic plants are planned, be sure to size it large enough to accommodate growth. Err on the larger size -- some dirt can always be added back if it seems too large. A koi pond should be at least four feet deep at its deepest point. One can vary the depths of the pond by creating shelves of dirt or rock.
- Determine location. The best place to put a pond is close to the house so that it can be enjoyed when someone is outdoors or inside. Also take into consideration rain run-off. This may contain chemicals from fertilizers and pesticides that can contaminate pond life. Avoid locating it too close to trees, otherwise a lot of time will be spent cleaning out leaves and other debris. If the pond will be growing only plants, be sure it gets a few hours of steady sun a day. For a pond containing only fish, shade will be adequate.
- Plan on water circulation. Although circulation is not a must, it can help aerate the water and clean out debris, if a filter is used. Plus, moving water is less susceptible to insect larvae growth like that of mosquitoes. Figure a waterfall or water jet into the design and a skimmer that will suck out the water. Be sure the skimmer is positioned so that the level of the pond water meets halfway up the skimmer box. If a waterfall will be used, gradually slope the pond away from the waterfall to direct water toward the skimmer. Check municipal building codes to see if a permit will be needed for the pond

**UNLEASH**  
— YOUR INNER —  
**WARRIOR**  
STYLE • POWER • STRENGTH



LEARN MORE AT  
[SPARTANMOWERS.COM](http://SPARTANMOWERS.COM)

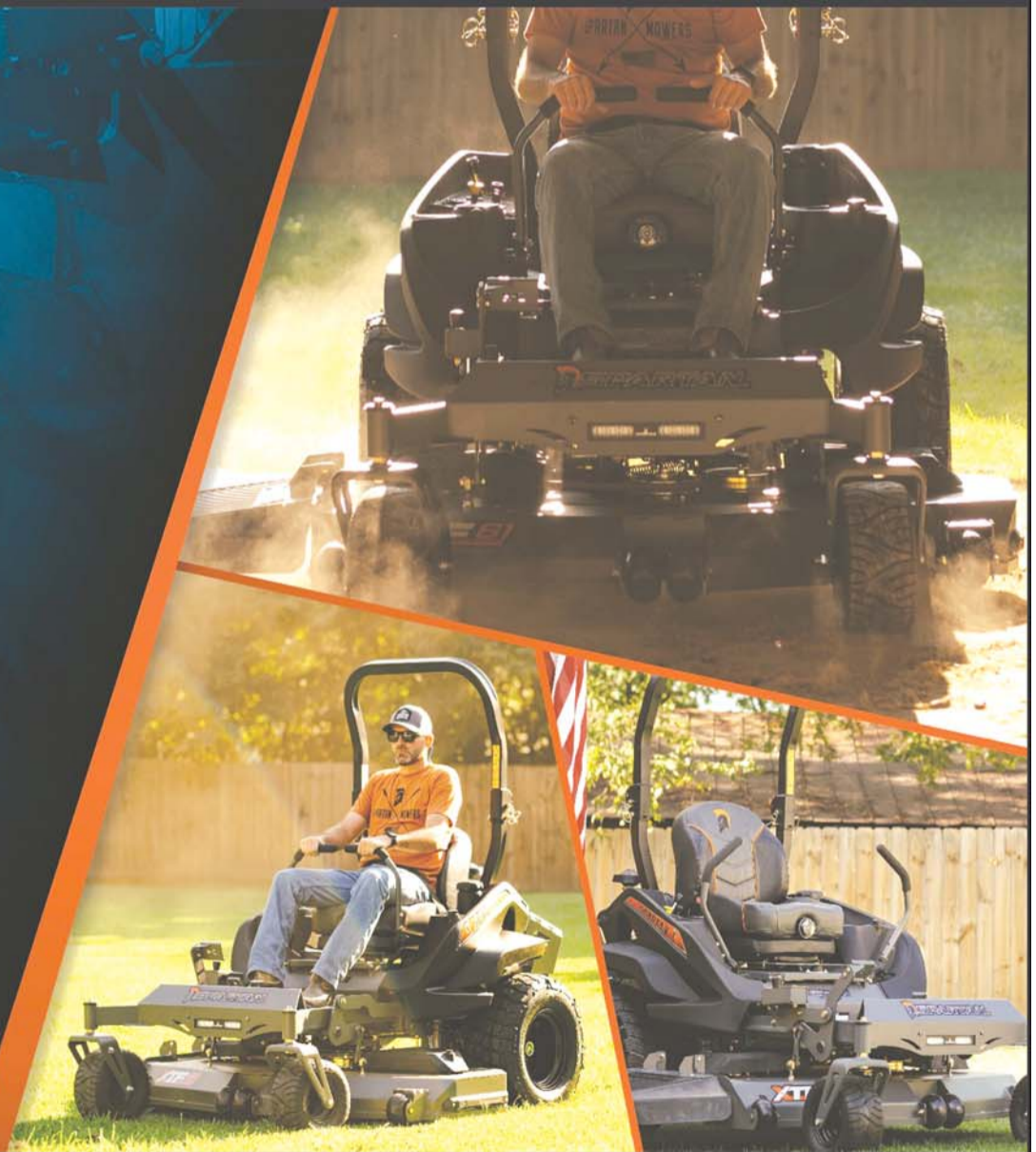

**Lawn & Garden Open House 9am - 2pm**

**WHITE'S**  
**FARM SUPPLY, INC.**

[WhitesFarmSupply.com](http://WhitesFarmSupply.com)

**April 6th**  
Canastota  
4154 Route 31  
315-697-2214

**April 13th**  
Waterville  
962 Route 12  
315-841-4181

**April 20th**  
Lowville  
8207 Route 26  
315-376-0300

**April 27th**  
Franklin  
387 Center St.  
607-829-2600



and the requisite plumbing/electrical work. There may be regulations as to how deeply the power line must be buried and other requirements.

- Purchase the correct liner size. Be sure to purchase the right size liner for the pond. Measure the maximum length and width of the pond. Double the depth of the pond and add it to these measurements. Add a foot or two for overlap and this will give you the pond liner size.

- Pay attention to rocks and gravel. Too much gravel at the bottom of the pond may cause noxious gases to build up that can gradually kill off marine life. Only put about 2 inches of gravel. Also, keep in mind that some rocks are better left out of the pond design. Limestone can affect the pH of the pond water making it very acidic. Try to make the pond look as natural as possible, hiding pipes and electrical switches with plants and other landscaping items.

- Fill and get started. Be sure to include some aquatic plants because those will help create the right mix of nutrients into the water that can feed fish and other plant life. There is also pre-packaged pond bacteria to prime the pond filter. Let the filter run a day or two before adding any fish to ensure that the water condition is right.

# Water Water Water... WE DRILL WELLS

- Professional Service from the Owner
- Knowledgeable
- Fully Insured
- Water Conditioning Service
- Complete Job from Well to Pump
- Pump Installation, Parts & Service



Member of the National Well Drillers Association

## Sergi's Well Drilling

Greene, NY

ESTABLISHED IN 1976

Mike Sergi  
Owner/Operator

**CALL TODAY**  
**607-656-8442**

NYS REGISTERED WELL DRILLER #10081

[www.sergiswelldrilling.com](http://www.sergiswelldrilling.com)

# 100+

## NEW & USED TRAILERS ON OUR LOT TO CHOOSE FROM!



Complete Line of Trailers In stock: Cargo, Snowmobile, Dump, ATV, Motorcycle, Car Hauler - Open & Enclosed, Equipment, Aluminum & Steel.

**North Norwich Motors**  
& TRAILER SALES, LLC.

Authorized Dealer For:



## Service:

- Parts
- Tires
- Brakes
- Hitches
- Custom Work
- Wiring
- Brake Controllers
- On-Site DMV
- Financing
- NYSI
- Accessories

Route 12, North Norwich  
Sales Hours: Mon.-Thurs. 7:30 am-6 pm; Fri. 7:30am-5:30 pm; Sat. 7:30 am-2 pm  
Service Hours: Mon.-Fri. 7:30 am-5 pm

**607-334-6956**  
[www.nonomo.com](http://www.nonomo.com)

Advertised vehicles may be subject to open safety recalls. Go to [safercar.gov](http://safercar.gov) or contact dealer for further information.



Tax, Title & Tags Extra  
\* Former Rental

### 12'x20' Cottage

Only **\$5,180**

OR

**Rent-To-Own**  
\$239<sup>81</sup> /mo. for 36 months



### 10'x14' High Barn

Only **\$3652**

OR

**Rent-To-Own**  
\$169<sup>07</sup> /mo. for 36 months



### 8'x10' Cottage

Only **\$2471**

OR

**Rent-To-Own**  
\$114<sup>40</sup> /mo. for 36 months



**FREE Delivery**  
first 20 miles

*Compare our quality and pricing, we think you'll be glad you did!*

**Yoder's QUALITY SHEDS**

278 ATSWELL RD., RICHFIELD SPRINGS • 315-858-0841  
MON-FRI 8 AM - 5 PM • SAT. 8 AM - 3 PM • CLOSED SUNDAY

# Why excavation is best left to the professionals

When shopping for a home, buyers often try to envision themselves living in a given property. Images of family gatherings and holidays may instantly come to mind, but prospective homeowners also may begin to envision changes they would make to a property if they were eventually to call it home.

Changing an existing structure or building an entirely new home on an empty plot of land can be exciting. Such changes typically require excavation, which is a complicated process that may be necessary for projects big or small.

#### What is excavation?

Excavation is the process of extracting material from the ground by digging. Earth, rock and other materials may be moved during the excavation process.

#### Can do-it-yourselfers excavate?

Skilled DIYers who have participated in excavation projects in the past may be able to handle a project on their own. However, it's important that homeowners recognize that excavation is about more than just digging in the ground. It's a complicated process that requires the use of specialized tools and equipment. In addition, a strong understanding of the land that will be excavated is required for the project to be safe and go smoothly.

#### Why hire an excavation professional?

Even the most skilled DIYer might be better off hiring an excavation professional than going it alone. That's true for a number of reasons.

- **Liability:** Homeowners who hire a fully licensed and insured professional excavation firm can rest easy knowing that they will not be responsible for



## COMFORT<sup>o</sup>

Achieve a whole new degree of comfort with LG Air Conditioning Technologies

- Personalized room-by-room control keeps everyone happy
- Control from anywhere via LG SmartThinQ<sup>o</sup> app on a smartphone
- Ducted and non-ducted systems offer broad design flexibility
- Industry-leading energy efficiency and superior heating

Discover why homeowners who choose LG Air Conditioning Technologies enjoy greater comfort.

- **Financing Available**
- **Ask Us About Rebate Savings**



Contact your local LG representative for more information:  
607-336-5572

6053 Co. Rd. 32, Norwich, NY 13815  
brothers@centralny.twcbc.com

**AVOLIO**  
— **BROTHERS, LLC** —  
Plumbing • Heating • Air Conditioning



any damages or injuries that may occur during the project.

- **Permits/requirements:** A professional excavation firm typically files all the necessary paperwork for work permits or can advise which permits homeowners will need to go forward with the project. In addition, professionals will know the local laws regarding building and excavation. For example, homeowners may be unfamiliar with the concept of lateral support, which refers to landowners' right to have their land physically supported in its natural state by adjoining land and underground structures. This is an important concept to understand during an excavation project, and professionals can advise homeowners if a project they want to undertake will violate lateral support laws.
- **Experience:** Perhaps the best reason to work with excavation professionals is their experience. A lack of excavation experience can result in damage to a homeowner's property and surrounding properties, which can prove costly. DIYers may not know the type of soil they have on their property nor recognize the different types of challenges each type of soil can present during an excavation project. Such knowledge comes with experience and is often invaluable. Skilled DIYers can tackle many home improvement projects on their own. However, the complex nature of excavation makes these types of projects the kind that are best left to skilled professionals. FH218165

# Wakeman 1 Gravel Bank



**Roll Off Dumpsters For Rent**

Unadilla, New York  
**Screened Gravel, Stone Products & Cobbles**  
 Delivery Available  
**607-434-4132**

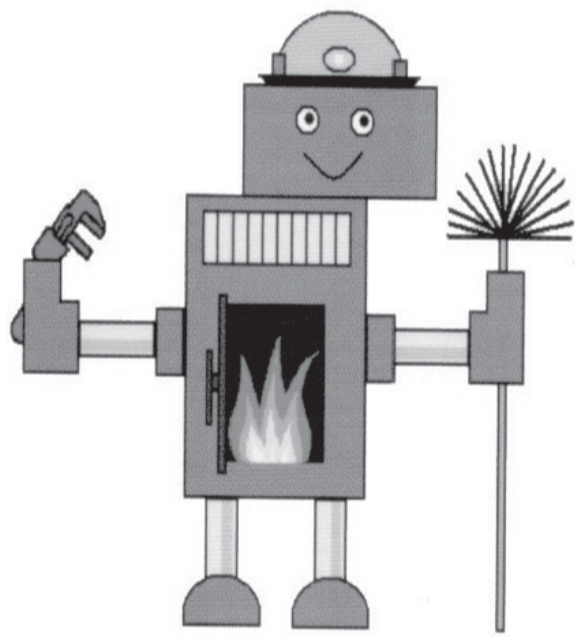

## Superior Heating & Air Duct Cleaning

**Kirk Gardner**  
**607-349-0831**

 **Like Us On Facebook**

Heating, Electric, Air Conditioning, Plumbing, Carpentry, Home Repair



Priceless Peace of Mind.  
 Low Monthly Premiums.

Trusted Insurance Solutions to Safeguard Your Family, Property & Future

- Life Insurance
- Business Insurance
- Homeowners • Renters
- Automotive • Motorcycle
- Marine



Call today for a comprehensive consultation and rate quote. We have the knowledge, experience and network to ensure you receive the best coverage for your needs at the best possible price.

Ask about our affordable umbrella policies!



**607-639-1930**  
 191 Main St.  
 PO Box 23, Afton, NY  
 roxannalrinker@yahoo.com



*"We Gotcha Covered!"*



## WEBSTER'S PAVING

- Blacktop
- Stone & Oil
- Sealing
- Patching

COMMERCIAL & RESIDENTIAL

**(607) 432-8550**  
**(607) 334-4849**

# INVEST IN YOUR ROOF

(MS) -- If your asphalt shingles are curling or your wooden cedar shake shingles have rotted out, it's time to look for a new roof. This major home improvement investment requires research and an understanding of roofing material options to make the best selection for your home. "There's only one type of roof I know of that is backed by a 50-year warranty and helps you save on

homeowner's insurance, and that's synthetic slate and shake roofing tiles," says Mark Clement, host of MyFixItUpLife.com radio show and website. "My own home is 100+ years old, so when it was time to replace our shingles, I researched every option available. "The DaVinci slate roofing tiles I installed look better than natural slate



**We can build the outrageous or elegant, the simple or complex structures.**

- Block Work to Framing
- Sheet Rock to Electric
- Kitchens to Bathrooms
- Post Beam to Custom Wood Work
- Land Clearing to Pond Building
- Patios to Retaining Walls and Everything in Between



**1-800-723-9092**  
**315-691-4900**  
*Don't be fooled by the Name. We're the Best in the Game!*  
**www.citiscapellc.com**  
Senior Citizen & Military Discounts

## Riolo & Son Construction

**Specializing in Kitchen and Bath Remodeling**

**Discover The Possibilities For Your Home!**

*Featuring the latest trends and design options in countertops, cabinets, lighting, tiles, fixtures and much more.*

**Military & Senior Citizen Discounts Available**  
Call Today for a **FREE Consultation**

**607-745-7914**

## Trim Specialties & Home Improvements

*Licensed & Insured*  
**Commercial & Residential**

- Window & Door Installations
- Cabinet Installations
- Countertops & Appliances Installed
- Flooring (Tiles, Wood or Laminates)
- Insulation
- Drywall/Sheetrock/Tape and Float
- Trim Work & Painting
- Framing
- Roofing (Metal or Shingle)
- Duct Work
- Concrete Work
- Demolition
- Minor Electrical
- Minor Plumbing
- Multi-Story House Leveling
- Stucco



**Discounts for Senior Citizens/ FREE ESTIMATES**



**ALEX BARRERA**  
**Phone**  
**607-373-7909**



**ALEX BARRERA**

TRIM SPECIALTIES & HOME IMPROVEMENTS

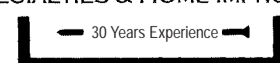

tiles. The look is so realistic that people pass by and can't tell the difference between them and real slate. They always bet me that these are real slate shingles. I come up a winner every time with these eco-friendly roofing tiles."

As Clement discovered, synthetic roofing tiles have many advantages over asphalt shingles, cement tiles and even real slate. "I appreciate the thickness and realistic look of the synthetic classic slate for our home's style, but I could just have easily chosen the Bellaforte snap-fit synthetic slate," says Clement. "Both are made from 100 percent pure resins and have colors and pigments infused throughout each tile. The idea that I could get a custom color to match my exterior really got my attention."

While the professional contractor chose to install synthetic slate tiles, the cedar shake style also caught his attention. "Testing shows that DaVinci shake roofing tiles last two to four times longer than real cedar shakes," says Clement. "They offer superior impact performance and maintain fire resistance over the entire product life cycle as opposed to their wood counterparts. Given that type of protection for the home, I can't see why anyone would select a real wood product that is subject to damaging weather conditions, insects and rot."

The recyclable synthetic roofing tiles are environmentally-friendly and can be requested in EcoBlend colors that actually help make the home more energy efficient. The award-winning

EcoBlend products have been rated by the Cool Roof Rating Council (CRRC) to reflect sunlight and heat away from the home.

For more information, visit [www.davinciroofscapes.com](http://www.davinciroofscapes.com) or [www.myfixituplife.com](http://www.myfixituplife.com). FH109856

**YOU KNOW IT'S TIME TO REPLACE YOUR ROOF WHEN ...**

Gaping holes and messy leaks are two obvious signs that a roof needs to be replaced. But, sometimes the signs are less obvious.

- Your neighbors have new roofs and you want to maintain the value of your home.
- Your neighbors have not added a new roof and you want to increase the resale value of your home.
- Your geographic area has seen an increase in severe weather conditions, (including hail or tornados) that require a stronger roofing material to handle the dramatic weather changes.
- Your existing roof is functional, but has staining that detracts from the look of your home.
- You want to switch to a low-maintenance roof that has a 50-year warranty.
- You don't want to worry about wood rot caused by wood shakes and termites.
- Excessive snow in your area has caused substantial damage to your roof.

*Too often, homeowners wait until their roofs are old and worn out before considering an upgrade,*

**Enchanted Gardens**

Family Owned since 1986

2975 NY Rte. 7

Harpursville, NY 13787

607-693-2755 • [www.enchantedgardens.us](http://www.enchantedgardens.us)



**LANDSCAPE CONSTRUCTION & DESIGN**

**Garden Center**

- Fruit & Flowering Trees
- Shrub Roses
- Shade Trees
- Flowering Shrubs (perennials)

**CALL 607-693-2755 TO CHECK HOURS**

*Coming Soon... Enchanted Emporium!*



**OFFICIAL OPENING APRIL 15 or by chance or appointment**

**CANAL STREET HARDWARE & SUPPLY**

**ALL YOUR AG & HOME IMPROVEMENT NEEDS UNDER ONE ROOF!**

If we don't have it and you need it, we'll get it!

**CALL US!**



We carry **KEYSTONE MILLS** Serving Agriculturists since 1900  
**FEED**

**For Your Lawn & Garden Needs!**

- Fertilizers and Peat Moss
- Garden Tools of All Kinds • Wild Bird Seed and Suet
- Garden Seeds • PLUS SO MUCH MORE!

• Best Pricing Around on Outdoor Drainage Pipes

• Interior & Exterior Valspar Paints, Cabot Stains & Supplies



3 South Canal Street, Oxford • 607-843-6929

Hours: M-F: 8 am- 5 pm Sat. & Sun.: 9 am- 2 pm

Canal Street Hardware and Supply LLC.



**Don't Buy a Pole Barn Package Until You've Contacted Us!**  
*We Offer Competitive Pricing and Guarantee Satisfaction.*

**POLE BARN PACKAGE**



**24' X 32' X 10' POST FRAME PACKAGE:**

*Designed to meet Your Needs*

**Call for current pricing**



**SHEDS AVAILABLE NOW!**

**Call Today for Your FREE Quote!**

- **MATERIAL PACKAGE**
  - Pre-Engineered Wood Trusses (6/12 Pitch, 4' O/C)
  - 4.125 x 5.187 Structural Glulam 3 Ply Eave Posts (8' O/C)
  - 4.125 x 5.187 Structural Glulam 3 Ply Gable Posts (10' O/C)
  - 2 x 8 Treated Skirt Boards (1 Row)
  - 2 x 4 Wall Girts (24" O/C) and Roof Purlins (24" O/C)
  - 2 x 10 Double Top Girt Truss Carrier
  - 1/4" M W I Dbl. Bubbl. Dbl. Foil Temp Shield Insulation on Roof
  - Beige Evertast II Traditional Steel Siding
  - Ivy Evertast II Traditional Steel Roof
  - One Bag of Concrete Mix Per Post Hole
- **DOORS & WINDOWS**
  - Two Clopay 9 x 8 4300 Series Ins. Overhead Door Ins. Stds
  - One 3' 9 Lite Entry Door
- **12" OVERHANG ON ALL SIDES W/ VENTED ALUM. SOFFIT**
- **FASTENERS**
  - 1 1/2 Inch Screw for Steel Wall, Roof Panels
  - 5 In. Ledger Lock Screw for Truss Carrier
  - 3 1/2 In. Galv. Pole Barn Nails for Skirt Board
  - Galvanized Steel Framing Nails
- **DETAILED BUILDING PLANS**

**MOUNTAINTOP Enterprises**

2726 State Hwy. 7, Bainbridge, NY  
(Located Between Rte. 8, Sidney and Bainbridge, NY)  
**607-967-4877**  
[www.metalroofingandmetalsiding.com](http://www.metalroofingandmetalsiding.com)



# Turn your bedroom into a relaxing retreat

Bedrooms are more than places to lay our heads at the end of the day. Bedrooms serve different functions, and not all are conducive to relaxation.

People who use their bedrooms as a work space may find they're compromising their well-being by introducing activities into the bedroom. The Sleep Foundation says having an office in the bedroom blurs the lines

## Homeowners should not skimp on comforters, sheets, duvet covers, and pillows for their beds.

between work and personal life, which can have serious effects on sleep. Rather, people should be looking to turn their bedrooms into relaxing retreats that offer a respite from the outside world.

• Use a neutral color palette. Neutral color palettes evoke a spa feeling. Walls can be painted white, beige or a light shade of gray. This can help the room feel calming and welcoming.

• Declutter the room. A sense of calm can be achieved simply by removing excess clutter. There is some evidence that the brain is more calm near an empty dresser, desk or clothes hamper. Therefore, removing excessive items from the room is a first step to making a nice retreat.

• Add soft lighting. Adjust the intensity and the color of the lighting in the bedroom. It should be subtle and warming. Dimmers enable homeowners

to adjust lighting as needed.

• Remove blue-light emitting devices. Computers, tablets, smartphones, and other electronic devices emit blue light, which

can compromise natural melatonin production in the body that contributes to sleep. Such devices should not be used at night in the bedroom.

• Invest in aromatherapy diffusers. Certain smells can create a relaxing mood. These may be sandalwood, lavender or jasmine. Utilizing their preferred scents, homeowners can employ reed diffusers in their bedrooms to enjoy the aromas of natural oils.

• Used closed storage. Open shelves and visible closet interiors may not hide a mess. Exposure to clutter can contribute to feelings of anxiety. Store items that shouldn't be on display behind closed doors or drawers.

• Bring in luxury linens. Homeowners should not skimp on comforters, sheets, duvet covers, and pillows for their beds. A cozy bed to dive right into can serve as the centerpiece of a bedroom retreat.



to adjust lighting as needed.

• Install an electric fireplace. There is something to be said for the relaxing effects of gazing into the flames of a fire. A crackling (faux-wood) fire is an added layer of indulgence in a bedroom.

• Add an area rug. Even in rooms with carpeting, an area rug under the bed can further define the perimeter of the bed and add extra plushness underfoot.

• Invest in aromatherapy diffusers. Certain smells can create a relaxing mood. These may be sandalwood, lavender or jasmine. Utilizing their preferred scents, homeowners can employ reed diffusers in their bedrooms to enjoy the aromas of natural oils.

• Used closed storage. Open shelves and visible closet interiors may not hide a mess. Exposure to clutter can contribute to feelings of anxiety. Store items that shouldn't be on display behind closed doors or drawers.

• Bring in luxury linens. Homeowners should not skimp on comforters, sheets, duvet covers, and pillows for their beds. A cozy bed to dive right into can serve as the centerpiece of a bedroom retreat.

Turning a bedroom into a relaxing space can help individuals sleep better and reduce anxiety. SH242658

## BULK MULCH SALES

- BROWN
- BLACK • NATURAL

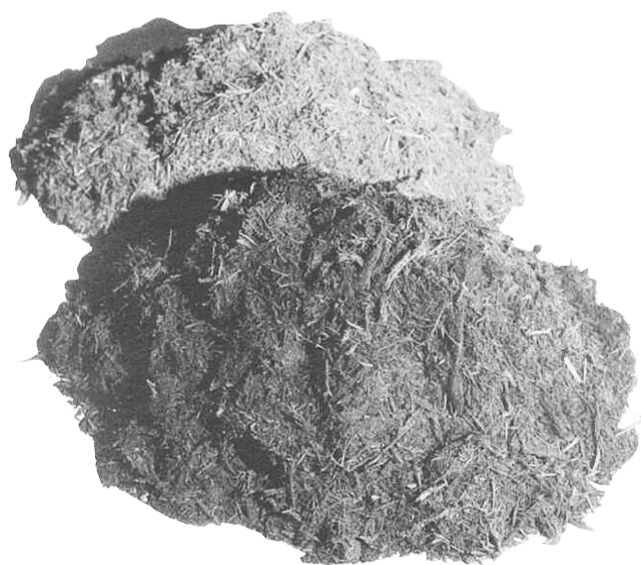

YOU PICK UP OR DELIVERY AVAILABLE  
Also screened topsoil available

# 607-334-9680

### Alpine Clippers Lawn Maintenance & Landscaping

603 Cnty Rd 44, Country Club Rd,  
Norwich NY 13815

## We Have The Missing Piece To Your Oldest Part

- Fluorescent Bulbs
- LED Bulbs and LED Fixtures
- Some obsolete circuit breakers still available
- 100–200 Amp Pole Services
- Lamp Repair
- Cord Replacement on Tools

## Homeowner & Electrical Contractor Supplies

### C.V. Electric Supply

Matt & David Ring  
46 Years In Business

12 Park Street, Norwich • 607-334-3292 • Fax 607-336-8324



# IMPACT MARKETING CONCEPTS



Specializing in crafting digital experiences that transcend the ordinary and amplify your brands impact in the online realm

- Website Design
- Graphic Design
- Social Media Management
- Google Business Management & Optimization
- Search Engine Optimization
- Google Display/ Search Ads

ImpactMarketingConcepts.com • 607-318-1289  
Powered by the Pennysaver



mahindra  
**SPRING  
SALES  
EVENT**

**GET 0%**  
OR SAVE THOUSANDS  
ON SELECT MAHINDRA MODELS\*

When the birds start chirping and the flowers start blooming, that's when the work starts calling. Get 0% or save thousands on a tough Mahindra tractor that will make this season's work a breeze. Learn how you can save by visiting your local, family-owned dealer or go to MahindraUSA.com today.

**NORWICH  
OUTDOOR POWER EQUIPMENT**  
5876 County Rd. 32- East River Road, Norwich  
607-334-4378  
www.norwichope.com  
8:00-5:00 Monday-Friday and 8:00-12:00 on Saturday

\*Available 0% APR financing on purchases of selected new Mahindra tractor models from participating dealers' inventory on qualified purchases through Mahindra Finance US LLC. A down-payment may be required for selected tractor models. Financing information is made available by Mahindra Finance USA LLC for discussion purposes only and is not a commitment to finance any transaction. The information provided is not intended and should not be construed as legal, accounting, or tax advice. All financing is subject to credit review and approval and other terms and conditions and is at Mahindra Finance USA LLC's sole discretion. Offer available for a limited time only and subject to change without notice.

**mahindra  
TRACTORS**  
**OFFICIAL  
TRACTOR  
OF TOUGH**

# American Dreams Built Here!

**Largest  
Selection In The  
Northeast**



**American  
HOMES**  
American Dreams Built Here

**Over 30  
Homes On Display**

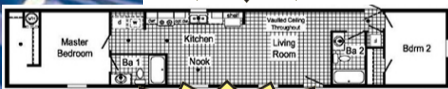

**Singlewides  
starting at  
\$66,995**

**Richfield Springs  
315-858-1600**

[www.americanhomescny.com](http://www.americanhomescny.com)

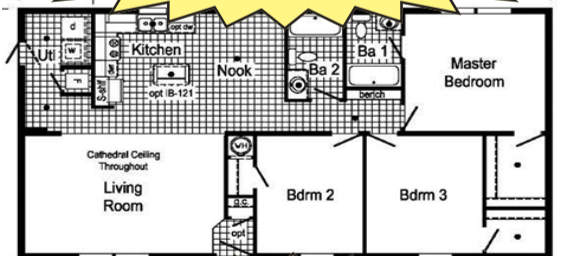

**Doublewides  
starting at  
\$94,995**

**Modular  
Ranches  
starting at  
\$139,995!**

**NEW  
NORTH  
CAROLINA**



**Modular  
Capes  
and  
2 Stories  
On Display**

**American  
Homes**

**FREE DELIVERY & SETUP  
WITH 60 MILES**

**SAVE  
\$5000**

**OHIO**



**New Era Ranch Home**

**SAVE  
\$17,000**

**WEST VIRGINIA**



**Amazing Value In This Home**

**Come see  
one of our  
representatives  
today and you  
can enjoy your  
new home by  
summer!**

**Visit Us At [www.americanhomescny.com](http://www.americanhomescny.com)**



**FAMILY OWNED AND OPERATED IN OXFORD SINCE 1989**



**LOOKING FOR A NEW KITCHEN OR BATH...  
COME TO THE #1 DESIGN CENTER IN CHENANGO COUNTY.**



Our designers have over 50 years of combined experience.  
**BUDGET TO CUSTOM, WE CAN HELP!**  
Call or stop in today to start your dream kitchen or bath.  
Flooring • Windows  
• Shower Doors  
• Countertops- Corian, Quartz, Granite & Laminate  
**NO INTEREST FINANCING** available to qualified buyers.  
Stop in for details.

**Ask about our Contractor Referral Program**

**• WINDOWS • DOORS • SIDING • AWNINGS  
• SCREEN & 3 SEASON ROOMS • SHEDS • PERGOLAS**

**• VINYL FENCE • ALUMINUM FENCE • CEDAR FENCE**

**• VINYL RAILING • ALUMINUM RAILING**

**• COMPOSITE DECKING • POLY DECKING**

**• DOCKS • CARPORTS • GARAGES • UTILITY & AGRICULTURE BLDS.**

**116 WARN POND RD., OXFORD - CALL FOR A FREE ESTIMATE 607-843-9834**

Hours: Mon., Tues., Wed., & Fri. 10 am-5 pm; Thurs. 10 am-6 pm; Saturday 9 am-1 pm

**YOUR COMPLETE  
BIG/LITTLE  
HOME CENTER**

- Kitchen Cabinets & Vanities**
  - Omega Framed
  - Omega Full Access Frameless
  - WF Cabinetry
  - WF Capital
  - JSI Cabinetry
  - Cubitac Cabinetry
  - Avance Cabinetry
  - US Cabinet Framed
  - US Cabinet Frameless
  - Backwoods Amish Built RTA
  - Kitchen Kompact
  - Amerock Cabinet Hardware
  - Wurth Cabinet Hardware
  - Richellu Cabinet Hardware
  - Rev-A-Shelf Cabinet Accessories
- Outdoor Kitchens**
  - Open Air Outdoor Cabinetry
  - Rock Run Aluminum Cabinetry
- Countertops**
  - WilsonArt Quartz
  - Silestone Quartz
  - Hanstone Quartz
  - Dekton
  - Sensa Granite
  - Coran Solid Surface, Quartz & Endura
  - Laminate - Custom & Postform
  - MSI Quartz
- Vanity Tops**
  - Quartz & Granite
  - Remee Cultured Marble, Granite, Quartz
  - Stone Central Granite or Silestone
  - Samuel Mueller Solid Surface
  - Swanstone Solid Surface
- Ceramic Tile & Stone**
  - Florida Tile - Wall, Floor, Backsplash
  - Merola Tile - Wall, Floor, Backsplash
  - Lungaro Backsplash & Specialty Tile
  - Earthen Treasure Granite, Marble, Stone Tile
- Sheet & LVT Flooring**
  - IVC Flexitec
  - Tarkett Fiberfloor
  - Floamation LVT Glue Down
  - Congoleum Triversa LVT Click
  - NextFloor StoneCast LVT Click
  - NextFloor Scratchmaster LVT Click
  - H\*Flor Pikes Peak Click
  - H\*Flor PRESTG Artistry Glue Down/Click
  - Trillium Cerameta LVT Glue Down
  - Generations Lineage LVT Glue Down
- Flooring**
  - BSL Hardwood
  - Elite Advantage Engineered Hardwood
  - Advanced Edge Sports Flooring
- Carpet**
  - NRF Select Carpet
  - Carpet Tile - Commercial & Residential
  - Indoor/Outdoor Carpet
  - Foss Carpet Tile
  - NEFS Carpet
- Shower & Tub Walls**
  - Samuel Mueller Solid Surface
  - Swanstone Solid Surface
  - Fibo Laminate
  - Wedi Tub & Shower Systems
  - Certified Wedi Pro Shower System Dealer
- Shower Doors**
  - Century Bathworks Shower Doors
  - Arizona Shower Door
  - Samuel Mueller Shower Doors
- Samuel Mueller Bath Accessories**
  - Grab Bars, Shelves, Towel Bars, Hooks,
  - Shower Niches/Storage Pods,
  - Shower Seats - Fixed & Stand Alone
- Maidstone Claw Foot Tubs, Kitchen & Bath**
  - Oak Pointe Stair & Railings Components
  - Wood, Metal, Cable
- CycloVac Central Vacuum Cleaners**
- Railings & Porch Posts**
  - Superior Plastics Vinyl
  - Superior Plastics Cable
  - Keylink Aluminum
  - Keylink Aluminum Cable
  - Eastern Illusions Vinyl Railings
  - Eastern Ornamental Aluminum
  - Evolve Solid Plastic Railings
- Decking**
  - Clubhouse Cellular PVC
  - MoistureShield Composite
  - Evolve Solid Plastic Lumber & T&G Decking
  - Renew Decking & Trim
  - Rhino Armadillo Decking
  - TruNorth Composite
  - Duxxbak Composite Decking
  - Aeratis Cellular PVC Porch Flooring
  - Siberian Larch Wood Decking
  - Western Larch Wood Decking
  - Lunawood Thermowood Decking
  - Tropical Hardwood Decking
  - Southern Yellow Pine Porch Flooring
  - Western Red Cedar Boards, Decking, Siding
  - Trimax Plastics Structural Plastic Lumber
  - ZipUP Underdeck Ceiling Panels
- Fencing**
  - Superior Plastics Vinyl
  - Keylink Aluminum
  - Masterlink Chain-link
  - Eastern Illusions Vinyl Fence
  - Eastern Ornamental Aluminum
  - Eastern Cedar
- Siding**
  - Royal Vinyl Siding
  - Foundry Vinyl Shakes & Siding
  - MidAmerica Shutters & Siding Accessories
  - Koma Cellular PVC Boards & Trim
  - Metal Sales Steel Roofing & Wall Panels
- Awnings - Retractable, Window, Door Pergolas, Sun Shades, Canopies**
  - Aristocrat Awnings
  - Sunair Awnings
  - Agecraft Aluminum Awnings
- Screen & 3 Season Rooms**
  - Ballew's Aluminum Screen Rooms
  - Ballew's Alum. Carport & Patio Covers
  - Ballew's Mobile Home Roof Overs
  - Ballew's Aluminum & Vinyl 3 Season Rms
  - Aristocrat Aluminum & Vinyl 3 Season Rms
- Outdoor Patio & Stone Veneers**
  - Adorn Firepits, Planters & Pavers
  - Genstone Veneer Panels
  - Adorn Mortarless Stone Panels
  - Interceramic Ledger Stone
  - Slimstone Stone Veneer Sheets
- Boat Docks**
  - Tommy Docks & Accessories
  - Techstar Dock Floats
  - Dockmaster Boat Ramps
  - DockEdge Dock Components & Accessories
  - American Muscle Dock Components & Accessories
- Doors & Windows**
  - NC Fiberglass & Steel Entrance Doors
  - Wood & Molded Prehung Interior Doors
  - Woodgrain Interior & Exterior Wood Doors
  - National Vinyl Sliding Doors
  - Larson Storm Doors
  - National Vinyl Replacement Windows
  - National Vinyl New Construction Windows
- American Steel Carports, Garages, Ag Blds**
- Catskill Sheds & Garages**

# Did you know?

Certain home improvement projects are more complex than others. Projects that involve working with gas lines are among the most complicated and risky undertakings, and even seasoned do-it-yourselfers are urged to leave such tasks to certified professionals. According to Angi, the average cost to move a gas line is between \$15 and \$25 per linear foot, and homeowners can expect to pay an additional \$1 to \$10 per linear foot for pipe materials. A natural gas plumber can install, extend and repair natural gas lines and ensure that the project is completed safely, on time and within homeowners' budgets. Angi notes that the average cost to move a gas line is between \$250 and \$750 for the whole project. However, if a buried line must be excavated, that cost could run into the thousands of dollars. SH222678

# Did you know?

It's no secret that a good-looking lawn can entice buyers when selling a home, but homeowners may not realize just how much they can benefit from even the smallest investments of time and money in their home exteriors. According to the Top Agent Insights Q2 2019 Report from HomeLight, low-cost outdoor home improvements to a landscape provide sizable returns on investment. For example, the report found that a \$268 investment in a lawn care service can lead to a \$1,211 increase in home value at resale. Similarly, \$340 worth of fresh mulch can increase home value at resale by \$769. More than 85 percent of real estate professionals recommended other small and simple projects, including removing dirt, grime and cobwebs from a home entrance and trimming trees and shrubs prior to putting a home on the market. GT224830



**LANDMASTER**

**READY TO WORK SALES EVENT**  
OFFER VALID ON 2023 MODELS ONLY.

**GAS MODELS**  
**\$1,000 OFF**

**NORWICH**  
**OUTDOOR POWER EQUIPMENT**

5876 County Rd. 32- East River Road, Norwich  
607-334-4378



[www.norwichope.com](http://www.norwichope.com)



8:00-5:00 Monday-Friday and 8:00-12:00 on Saturday

**RETRACTABLE FABRIC ROOF & LOUVERED PERGOLA® AWNINGS**

SUNAIR AWNINGS AND PERGOLAS OFFER ENDLESS POSSIBILITIES AND ARE THE ULTIMATE PROTECTION FOR YOUR PATIO OR DECK.





MOTORIZED ADJUSTABLE PERGOLAS      RETRACTABLE PATIO AWNINGS      ROLL DOWN BUG SCREENS

UP TO **\$250 OFF**

**SUNAIR® OR SUNTUBE® MODEL LATERAL ARM SUNAIR**

With this coupon. Must submit at time of order. Not valid with other offers or previous sales. Offer available on installed lateral arm awnings only purchased at regular price. Expires 7-30-24.

**AGP PELLET STOVE**

BURNS ALL GRADES OF WOOD PELLETS

*The Most Reliable Pellet Stove on the Planet!*

- Easy To Operate
- Easy To Maintain
- Easy To Live With



# No Power? No Problem!



LOPP ENDEAVOR WOOD STOVE      FIREPLACE XTORDINAIR® FIREPLACE XTORDINAIR® 864 TRV 40K GAS FIREPLACE

Don't be left out in the cold this winter. A Fireplace Xtrordinair® or Lopi® hearth appliance can provide your family with warmth & comfort even when the power goes out! P.S. - You can even use your Lopi to cook on! Now is the perfect time to invest in a beautiful Fireplace Xtrordinair® or Lopi® gas or wood heater. Come see our vast selection of fireplaces, inserts and stoves that can add the ambiance of fire to any home. Talk to us about your creative vision of fire and let us help you ignite the fire within.



**OPERATION BBQ RELIEF**  
[www.bbqrelief.org](http://www.bbqrelief.org)



**COUNTRYSIDE**  
**STOVE & CHIMNEY**

116 Warn Pond Rd., Rte. 12 South, Oxford  
**607-843-2000**

Hours: Mon., Tues., Wed., & Fri. 10 am-5 pm; Thurs. 10 am-6 pm; Saturday 9 am-1 pm

[www.countrysideoxford.com](http://www.countrysideoxford.com)

 Follow us on Facebook for Recipes & Specials

# Our Customers Are Our First Priority



Office Staff: Tom Kelly, Justine Tumilowicz, Sarah Newell, Mike Edwards



Clyde Treacy & James MacDuff

## Our Pledge...

Our Customers are our first priority. Reese Marshall is here to serve you with your heating and cooling needs. We Pledge to constantly reaffirm this with our actions, which we have built our reputation on.

## We Offer...

- Free estimates for all installations
- Automatic delivery with a guarantee
- 24-hour emergency service, 365 days a year
- A variety of budget and burner service plans
- People who care about providing quality service

## Our Area of Service...

Reese-Marshall Co. Inc.'s office and storage facility is located on County Road 32, in Norwich. Our service area extends to Norwich and the following areas:

- Oxford - McDonough - Guilford - Preston
- Mt. Upton - Gilbertsville - Morris
- South New Berlin - New Berlin - Edmeston
- South Edmeston - West Edmeston - Pittsfield
- Sherburne - North Norwich - Earlville - Columbus Smyrna
- Otselic - South Otselic - Pitcher - Plymouth
- Sidney - Bainbridge
- Hamilton - Madison - Morrisville - Brookfield

## Quality Products...

Reese-Marshall Co. Inc. carries a full line of quality fuels including B-10 Heating Oil, Diesel, Gasoline and Propane Gas.

Our Burner Service Department is fully equipped to handle any repair or installation.



## Safe Quality Heating Systems



**Buderus**

**Rinnai**

**Thinking of a new heating system?  
Don't hesitate to call for a free written estimate.**



**REESE-MARSHALL**

*We make warm friends and keep you cool.*  
since 1942

6254 County Road 32, Norwich, NY 13815

**PHONE (607) 334-3633**

www.reesemarshall.com • email: info@reesemarshall.com

# Prevent home electrical fires

A person's home should be a safe haven. Too often, however, there may be dangers lurking in a home that can compromise the safety of residents.

Electrical fires are no joke. The Hartford insurance company says electrical failure or malfunctions account for almost 34,000 home fires per year. The National Fire Protection Association says they can contribute to 440 deaths and \$1.3 billion in direct property damage annually.

Older homes may be most vulnerable to electrical fires, as such structures were not designed to handle the demands of modern living. The insurance experts at Nationwide say half of all homes in the United States have electrical systems that were installed before garage door openers, high-tech coffee makers, and many computers became must-have items. And the Electrical Safety Foundation International says homes built before 1973 with overloaded electrical systems pose a number of safety threats.

Overloaded circuits are not the only contributor to electrical fires. Damaged wiring characterized by worn, frayed or loose wires can cause fires.

Malfunctioning appliances or those improperly maintained also can create home fires. Another contributor is poorly installed extension cords and power strips, as well as faulty outlets and switches around homes.

Homeowners can take various steps to reduce the risk of electrical fires at home.

- Install arc fault circuit interrupters. AFCIs are special types of circuit breakers that help prevent fires caused by nicked or frayed wiring. An AFCI gets tripped and cuts off power when an electrical problem is detected before a fire can start. In 2022, the National Electric Code started requiring AFCIs in bedrooms, and by 2017 they have been mandated throughout homes.
- Conduct a home electrical inspection. All homes more than 40 years old should be inspected to ensure their electrical systems can handle modern demands, says Nationwide. A qualified electrician can make recommendations regarding replacing breakers and suggest other modifications to improve safety.
- Utilize a monitor. Ting from Whisker Labs monitors a home's electrical

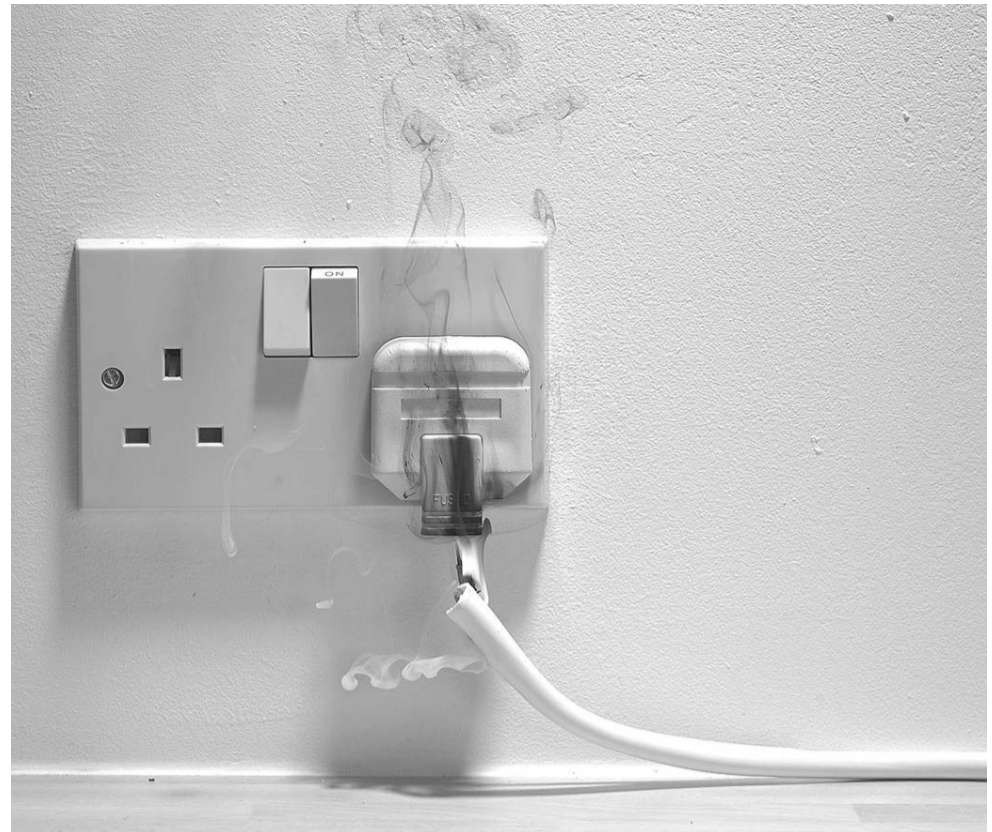

network using a smart plug-in sensor that is designed to detect hazards. The company indicates micro-arcs and sparks that develop are precursors to electrical fires.

- Turn to automatic shut-offs. Homeowners can utilize appliances and additional devices that automatically shut off after a set period of time. This can reduce the risk of overheating.
- Rely on timers or smart devices. Timers and smart home devices can give homeowners control of electrical components like appliances or lights from a remote area. This enables users to turn an appliance on or off to reduce overheating or avoid additional risk factors for electrical fires.
- Don't go DIY. Choosing to work with a professional electrician rather than doing electrical work oneself can help reduce electrical fire risk considerably. Electricians know how to work on electrical systems safely to prevent damage to wires and components, and also safeguard themselves against shock.

Risk for electrical fires at home can be reduced with technology and other strategies. TF245950

## UPSTATE TOOL & EQUIPMENT LLC

RASMUSSEN  
RENTS

See Us for All Your Rental Needs!

### Welder & Cutting Equipment

#### Heaters- All Sizes

Forced Air Multi-fuel Heater  
175,000 BTU Residential & Commercial

#### Power Tools

1/2" Hammer Drill 28V  
Demo Saw  
Power Broom  
Air Jack Hammer  
Electric Jack Hammer (w/bits)  
Paint Sprayer

#### Power Equipment

Generator  
Pressure Washer  
10" Tile Saw  
2" Sump Pump  
Appliance Hand Truck  
Post Hole Drill  
Walk Behind Brush Hog  
Log Splitter  
Walk Behind Tiller  
Trencher Earth Saw  
Floor Sander

Now Open  
At Our New Location  
Just Outside Of  
Oxford!

- Skid Steers
- Backhoes
- Attachments
- Dozers
- Excavators
- Rollers
- Loaders
- Lifts
- Telehandler
- Off Road Trucks
- Trailers
- Golf Carts
- Side by Sides

WE RENT TO  
HOMEOWNERS  
& CONTRACTORS

Rentals by  
the Day,  
Week or  
Month

285 Wackford Rd., Oxford, NY 13830

607-244-0252

upstatequalityrental@icloud.com

Open Mon.-Fri. 7:30-4:30, Sat. 7:30-noon, Closed Sun.

Opening  
Friday, April 26th!

# Gretna Gardens

(formerly Otsdawa Greenhouse)

Beautiful hanging baskets,  
impatiens, geraniums & more!

Stop and See  
All We Have For **You!**

## Gretna Gardens

"We Make Your Day Beautiful"

2664 State Highway 7 • Otego, NY

607-267-1707

Hours: Mon.-Sat. 9 am - 6 pm; Sun. 9 am - 5 pm



# How empty nesters can repurpose bedrooms in their homes

It can be bittersweet when adult children decide the time has come to move out of the family home. Parents perhaps get their first trial run of this scenario when their children go off to college or enlist in the military. Rooms are left empty, if only for a certain period of time. Eventually, those

**Those who have been setting up “desks” at dining room tables or elsewhere may be excited about the prospects of finally having a private, dedicated space to work from home**

rooms will remain empty as adult children move out of the house for good. Converting a child’s bedroom into an area for adults may take some planning. It can be exciting to regain space, but at the same time, it can be disheartening to convert a child’s bedroom once and for all. When the time comes and homeowners are emotionally ready to tackle bedroom conversions, these tips can help the process go smoothly.

• **Repurpose the space for them.** Give a childhood bedroom an adult spin without changing too much. If furniture is in good shape, replace the bedding, change the flooring, swap out artwork, and remove “youthful” items like toys, trophies and other collectibles. When the child comes home to visit, he or she will still feel comfortable in the space.

• **Create extra storage.** The bedroom can be transformed into a walk-in closet or dressing space. According to the design experts at Houzz, many clients request this type of dressing room situation. There’s a bonus if the



layout allows the space to connect to the owner’s suite or bathroom. This is a major overhaul, so homeowners should enlist a professional contractor.

• **Make a fitness center.** A bedroom can be turned into a home gym to make working out more convenient. Homeowners should take inventory of equipment they may have and then figure out where existing and new equipment will go. They may need to consult a structural engineer to ensure that the flooring can bear the weight of additional equipment.

• **Create a work space.** One of the best ways to transform adult children’s bedrooms is to convert the spaces into home offices. Those who have been setting up “desks” at dining room tables or elsewhere may be excited about the prospects of finally having a private, dedicated space to work from home.

• **Turn it into a craft room.** The bedroom can be converted into a space to explore hobbies and various other interests. A dedicated craft space, a reading nook, a place to store photography equipment, or another function can serve as a useful way to repurpose an empty bedroom. Empty nesters have many possibilities when it comes to converting their children’s old bedrooms into adult spaces. SH242650

## The Glass Man GLASS & MIRROR



- TABLE TOPS
- PLEXIGLASS
- TEMPERED SAFETY GLASS
- LAMINATED SAFETY GLASS
- INSULATED GLASS
- SCREEN & WINDOW REPAIRS
- SHOWER DOORS

Glin Tatum  
glintatum@aol.com  
**607-624-0615**

3498 State Hwy. 12  
Oxford, NY  
13830

Hours: Wed. - Sat.  
10 to 5

## When Is The Best Time To Schedule My Pool Opening?

# RIGHT NOW!



Please call us to schedule your swimming pool opening at **607-336-7665** to be put on the April calendar as soon as possible and to check out any special discounts.



5454 State Hwy. 12 • Norwich, NY  
**607-336-POOL** (7665)  
www.bdpoolspa.com  
E-mail: office@bdpoolspa.com  
www.facebook.com/bdpoolspa  
Creating backyard memories since 1976



# Recycle The Right Way



- 1) All containers must be clean & covers removed
- 2) All paper dry & free of plastic
- 3) In the right bin

#1 – see through plastic	= #1 PETE
#2 – colored plastic jugs & bottles	= #2 HDPE Colored
#2 – milky color plastic jugs & bottles	= #2 HDPE Natural
#5 – tubs	= #5 PP
all metal food & drink cans	= Tin Cans
clear glass food & drink containers	= Clear Glass
most wine bottles	= Green Glass
most beer/yeast bottles	= Brown Glass
junk mail/magazines/paper	= Junk Mail
newspaper/pennysaver	= Newsprint
cardboard boxes / kraft paper	= Cardboard*

\* *Waxy or plastic coated cardboard is garbage.*

All **CLEAN** recycling is **FREE!**

## Household Batteries

(just tape ends with clear tape)

## Fluorescent Light Bulbs

(limit 2 per day per resident)

## We Also Accept All Electronics

### 3 Convenient Locations

#### 1) NORTH NORWICH TRANSFER STATION

– 6701 NYS Hwy 12, Norwich  
M 8–noon, T-Sat 8–4

#### 2) BRISBEN TRANSFER STATION

– 177 Coutermarsh Rd., Greene  
M 8–noon, T-Sat 8–4

#### 3) PHARSALIA LANDFILL

– 439 CR 47, Norwich  
M–F 8–4, Sat 8–noon

### KEEP YOUR COMMUNITY SAFE!

Batteries placed in the garbage or curbside bin can be damaged and cause fires or contaminate our water supply. Be sure to remove the battery from your device, tape both ends and recycle your batteries separately at our facility.

Watch for upcoming recycling programs at the landfill and transfer stations.

**For all recycling and trash disposal questions  
call 607-337-1792.**

# Low-cost ways to revamp living areas

Home improvement projects require substantial financial investment. But just because a homeowner wants to bring a fresh look indoors doesn't mean he or she has to break the bank along the way.

Living rooms are some of the most frequently used spaces in a home, and they can use an update from time to time to stay on trend or to make the area more functional for a changing family dynamic. Here are some budget-friendly ideas for breathing new life into living room designs.

- Establish the budget. Homeowners should figure out how many dollars they can designate to a living room makeover before purchasing supplies or hiring out the work. Figure out the scope of the remodel, visit stores or suppliers to price out materials, get estimates from contractors, and then plan for some unforeseen circumstances along the way to determine if this type of renovation is affordable. If not, scale things back until the project more closely aligns with your budget.
- Change the paint color. Lighter and brighter colors are on trend. A can or two of paint can do wonders for updating a space without a large financial commitment. Pair that new paint color with new window coverings and complementary throw pillows to pull the theme together with minimal expense.
- Update the flooring. Tired, outdated carpeting or other flooring can use an overhaul. While solid hardwood flooring may be preferable, there are many types of laminate flooring that mimic the looks of popular wood colors and styles for a fraction of the cost. Plus, many are sold at home improvement retailers and even at warehouse clubs or online for reasonable prices. Laminate flooring also may be a potential DIY job for a skilled homeowner, saving even more money.
- Introduce a fireplace. Fireplaces were once hot commodities, but that

popularity waned in the 1970s and 1980s.

Homeowners with chimneys may discover a fireplace was boarded over and the bare bones still exist that can be renovated to bring back character. There also are ventless freestanding units that are quite affordable that can mimic the look of a built-in fireplace.

- Reupholster instead of replace furniture. There's no need to throw away quality furniture if the fabric is the only thing impeding design. New upholstery or even a slipcover can update designs.
  - Conquer clutter. Rather than adding something to the living room, remove clutter to give the room a more airy feel. This can instantly change the look of the room. Use cord covers to tame plugs for electronics and remove unnecessary furniture from the room.
  - Improve lighting. Another easy and often inexpensive fix is to change lighting fixtures, including using brighter, more energy efficient LED bulbs, and to assess lighting needs to eliminate dark corners of rooms that can make the space seem drab.
- Living room spaces in need of an update often can benefit from improvements that go easy on the wallet. SH222677



• COUNTERTOPS • CORIAN • GRANITE •



## Designing a new kitchen or bath is easy when you let us help you!

*The Ultimate in Quality Craftsmanship and Materials*



### Beautiful... Cabinetry



- by RCW, Artisan & Wolf
- Custom, Semi-Custom, Stock and More!



### Countertops

- Granite • Quartz • Corian
- Laminate • Porcelain • Solid Wood



Kitchens, Baths, Windows, Doors & Countertops

27 Smith St., Sidney, NY • 607-563-3400

Hours: Mon.-Fri. 8-4:30; Sat. 9:00-Noon or call for private appointment  
www.TandGCustomCabinetry.com

• SUNPIPE • PORCH ENCLOSURES

• QUARTZ • LAMINATE • SOLID WOOD

• STAIRCASES • RAILING SYSTEMS • WINDOWS • DOORS – FINISHED or UNFINISHED





# Steel Sales Inc.

## Open To The Public

P.O. Box 539, 8085 State Hwy. 12  
Sherburne, NY 13460



## Your Source for Steel, Stainless, Aluminum & More

Structural Shapes & Bars



Sheet & Plate Products



Concrete Reinforcing Products



Piles Decks & Grates

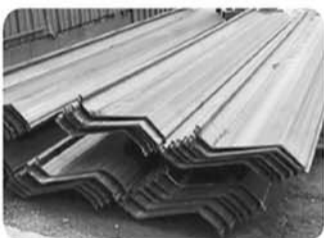

Additional Building Materials



Tube & Piping



Drainage Products



Snow Plow & Heavy Equipment Wear Parts



## Custom Fabrication

350 Ton Press Brake



High Definition Plasma Table



OMAX Water Jet



Monarch Vertical Milling Machine



Plate Roller



Cincinnati Hydraulic Shear



800-238-7833 or 607-674-6363

Fax: 607-674-9706

[www.SteelSalesInc.com](http://www.SteelSalesInc.com)

## Metal Roofing & Siding



CLIP 'N SAVE!

# ASPHALT PAVING

Residential • Commercial  
 Driveways • Parking Lots  
 New Work • Repairs • Seal Coating  
 Concrete Sidewalks



Driveway  
 & Parking Lot  
 Sealing

**Yacano's**  
 PAVING  
 607-336-1400

CLIP 'N SAVE!

# Signs of septic system malfunction

Homeowners recognize that their work is never done. Homes require maintenance that runs the gamut from daily tasks like cleaning kitchen countertops to more significant undertakings like replacing roofs. For many homeowners, keeping their homes running smoothly involves tending to septic systems.

Estimates from various sources indicate that roughly one in five homes in the United States has a septic system. Homeowners who live in areas with regional sewage systems may not give much thought to the operation and maintenance of their wastewater and disposal system. But that responsibility typically rests squarely on the shoulders of homeowners whose homes have septic systems. Learning to maintain septic systems so they operate safely and efficiently is essential. Homeowners should know that recognizing signs of septic system malfunction is vital to avoiding potentially costly, messy accidents that can put the health of humans and local wildlife in jeopardy.

### What happens when a septic system malfunctions?

The Washington State Department of Health notes that a malfunctioning septic system is a threat to the health of both humans and animals as well as the environment. When a septic system is malfunctioning, untreated sewage can be released and end up in places where it shouldn't be, such as groundwater, surface water and marine water. That's true even if it's not visible to the naked eye. Humans and animals are in danger when septic systems malfunction because

# VEP / WALDRON'S

## KITCHEN CABINETS:

### Showplace Cabinetry



Residential and commercial carpet, luxury vinyl, ceramic tile, & remnants.

**Carpet and Vinyl Remnants available at Discounted Prices**

- Huge Selection of Quality Flooring

**Wall to Wall**

**WE'VE GOT YOU COVERED!**

- Financing Available

## Speed Queen

**WASHER**  
 #Tr3003wn  
**\$1149**

**ELECTRIC DRYER**  
 #Dr3003we  
**\$1149**

— 3 year warranty —



FRIGIDAIRE  
 KitchenAid



Located at 89 Main Street, Sidney NY 13838

Hours: Mon.-Fri. 9 am - 7 pm; Sat. 9 am - 12 pm; Closed Sunday

607-563-1434 • www.vepappliance.com

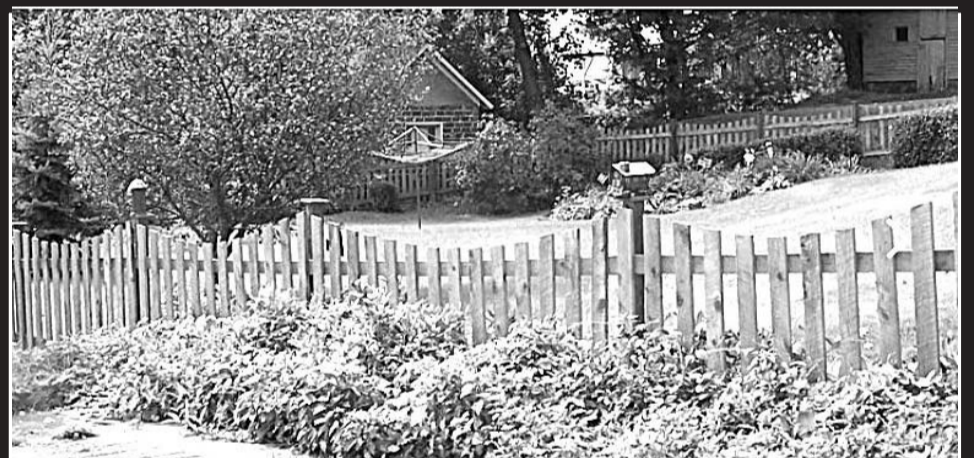

## Chenango

Fence & Deck Company

All Fence Types including Chain Link & Vinyl

Custom Decks

Installation & Repair

Supplies

Call: (607) 316-8486

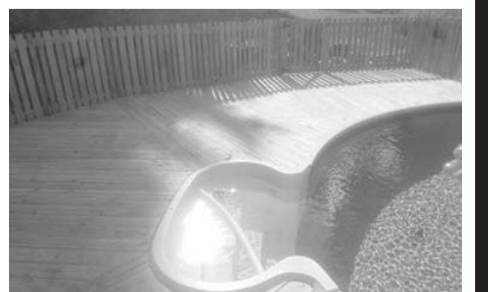



untreated sewage contains pathogens and other contaminants that can make them sick.

**What are the signs of a malfunctioning septic system?**

The DOH of Washington State notes that properly maintained septic systems should provide reliable service for many years. Part of that maintenance is keeping an eye out for these signs that suggest a system is malfunctioning or failing:

- Water and sewage from toilets, drains and sinks is backing up into the home
- Bathtubs, showers, and sinks drain very slowly
- Gurgling sounds are coming from the plumbing system
- Standing water or damp spots near the septic tank or drain field
- Bad odors around the septic tank or drain field
- Bright green, spongy lush grass over the septic tank or drain field, even during dry weather
- Algal blooms in nearby ponds or lakes
- High levels of nitrates or coliform bacteria in water wells

Homeowners with septic systems should make tending to those systems part of their routine home maintenance. FH218209

# MOVING, REMODELING, OR JUST CLEANING UP?

CASELLA MAKES DUMPSTER RENTAL EASY!



THE RIGHT SIZED DUMPSTER



WHEN YOU WANT IT



WHERE YOU WANT IT



REMOVED WHEN YOU SAY SO



**TAKE \$25 OFF**  
YOUR NEXT DUMPSTER RENTAL!\*

Get a quote today,  
call **800-CASELLA**

\* Offer is limited to delivery, removal and disposal of one temporary dumpster service per customer. Please call for dumpster sizes, pricing and availability.



RECYCLING • SOLUTIONS • ORGANICS • COLLECTION • ENERGY • LANDFILLS

casella.com



# BUILDING YOUR DREAM HOME JUST GOT MORE AFFORDABLE

## Start Your Build. Just Pay Interest.

Make interest-only payments as stages of your home are being completed, plus you can manage your loan online for faster funding and real-time updates. Once your build is complete, you'll start making combined principal and interest payments. **Now, let's start building together!**



Construction loans made easy.  
Scan to see how NBT Bank can get you moving!



Get started today at [www.nbtbank.com/construction](http://www.nbtbank.com/construction)

Member FDIC  
EQUAL HOUSING LENDER

# Unbeatable Prices!

...on these very popular products



## Lauzon Red Oak

Natural 3/4" solid hardwood flooring

Less than what other dealers pay for it, and lower than online sellers' price!

Now Only **\$4.99** per sq. ft.

In Stock Now!

**FREE DELIVERY** to Chenango & Delaware Counties

## Grid Scale Porcelain Tile

12"x24" in 2 colors- Gris and Concrete

Compare our price to any big box store or on the Internet... **HUGE SAVINGS!**

Now Only **\$1.99** per sq. ft.

Step Up To National Floor Center...

# National FLOOR CENTER

National Floor Center Main Showroom

46 South Washington Street

Binghamton, NY 13905

**607-296-4302 / 607-772-1212**

Open Mon-Fri 9 am-7 pm, Sat 9 am-5 pm

[www.nationalfloorcenter.com](http://www.nationalfloorcenter.com)

